



DATA SHEET

Polycom® MSR Series

Perfect combination of Skype for Business ease of use and Polycom's proven voice and video technology

Polycom® MSR Series is the next generation Skype Room System that combines the familiar Skype for Business experience with Polycom's leading audio and video peripherals that enhance the overall meeting experience. Designed to deliver the utmost simplicity and ease-of-use, Polycom MSR Series comes with the center-of-room touch controller, powered by Microsoft® Surface® Pro tablet running in console mode. From a familiar user interface, you can start a meeting scheduled in the room with just one touch, or type a few names and launch an ad hoc call, just like you would with your own tablet computer. No training required. The MSR Dock expands the connectivity of the Surface Pro and connects to existing room displays and the network. This enables certified Skype Room voice and video peripherals, as well as an HDMI content source, to be connected at the same time. Combination of extremely easy-to-use touch control console and Polycom's proven audio and video peripherals enhances the overall meeting experience for everyone.

Legendary voice quality

No matter if you join a call from a huddle space with a few team members or from a larger conference room, Polycom MSR Series offers the premium voice quality that is so essential in remote video collaborations. You can rest assured you will hear and be heard clearly no matter where you sit in the room, so there is no need to remind yourself to lean in or raise your voice each time you speak. Polycom audio innovations provides the best possible speakerphone experience. Polycom® HD Voice™ with industry-leading full duplex, echo cancellation, and noise reduction produces crisper sound quality and reduces fatigue. Polycom® NoiseBlock™ automatically mutes the microphone when a user stops speaking, silencing ambient noises that can interrupt conversation.

Solution for every room size

Polycom MSR Series comes in multiple configurations and offers the optimal experience for each room size. The MSR100 and MSR200 offer great experience in huddle and small rooms. The MSR300 includes the flagship conference phone and the powerful pan-tilt-zoom camera with 12x optical zoom, to cover up to a large conference room. The MSR400 provides a unique center-of-table experience with 360-degree view of the room as well as automatic speaker tracking, great for medium size rooms. The MSR500 offers a packaged solution, perfect for deploying consistent experience across multiple rooms and locations.







Benefits

- **Familiar Skype for Business Interface**—Familiar user interface and the Skype for Business functionality make it easy for everyone to use
- **Powerful audio and video experience**—Industry-leading Polycom voice and video solutions enhance overall meeting experience in the room and for far-end participants
- **Easy to manage**—Software updates via Windows Update, and management using standard Microsoft management tools such as Intune and OMS

Key features

- **Polycom® HD Voice™**—Experience legendary audio conference quality
- **Polycom® NoiseBlock™**—Be heard clearly with noisy background distractions removed

	MSR100	MSR200	MSR300	MSR400	MSR500
					
Room Size	Huddle	Small	Medium to Large	Medium	Medium to Large (Packaged Solution)
Audio Device	Polycom® VoxBox™	Polycom Trio™ 8500	Polycom Trio™ 8800	Polycom® CX5100	Polycom Trio 8800
Microphone pickup range	10 ft (3m)	14 ft (4.2m)	20 ft (6m)	20 ft (6m)	20 ft (6m)
Loudspeaker Frequency Response	200Hz-14KHz	180Hz-14KHz	100Hz-22KHz	160Hz-22KHz	100Hz-22KHz
Volume (at 0.5m peak volume)	83dB	90dB	92dB	88dB	92dB
Optional Extension Mic	No	Yes	Yes	Yes	Yes
Video Device	Logitech® C930e	Logitech® C930e	Polycom® EagleEye™ MSR	Polycom CX5100	Polycom EagleEye MSR
Pan/Tilt/Zoom	No	No	Yes	NA/ Active speaker switching/ 360° Panorama video	Yes
Zoom	No	No	12x Optical Zoom	No	12x Optical Zoom
Field of View	90°	90°	72.5° Horizontal/44.8° Vertical +170° pan and 120° tilt	360° Panorama with automatic active speaker switching	72.5° Horizontal/44.8° Vertical +170° pan and 120° tilt
Packaged Solution	N/A	N/A	N/A	N/A	Polycom® RealPresence® Medialign™ for MSR (includes single or dual display and furniture)

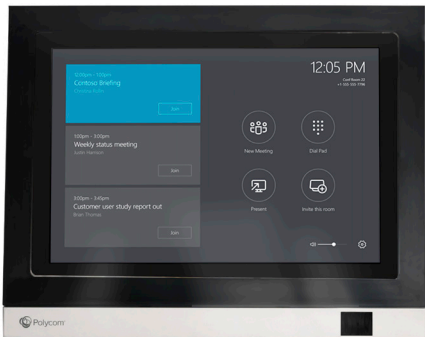

Front view of Polycom MSR Dock



Rear view of Polycom MSR Dock

Product specifications

Polycom MSR Dock with Surface Pro

- Surface Pro (2017, i5/128GB/4GBRAM)
- Integrated Microsoft Surface connector
- 2 x HDMI outputs supporting up to 1080p60
- 1 x HDMI input supporting content sharing up to 1080P60
- 1 x Gigabit Ethernet (RJ45) port
- 4 x USB 3.0 ports
- 1 x 3.5mm headset audio jack/TTY port
- IR Motion sensor

Power supply

- 100–240v AC power 50Hz/60Hz

Dimension

- 13.0/9.87/5.67(in)/ 330.2/250.7/144(mm) (W/H/D)
- Weight (without Surface Pro) 5.3lb/2.4Kg

Polycom MSR Dock with Surface Pro includes the following components*

- Surface Pro (2017, i5/128GB/4GBRAM)
- Quick Start Guide
- 1 x 6.5ftv(2m) HDMI cable
- 1 x 6 ft (1.8m) CAT5 network cable
- Power supply
- Assembly tool
- For specifications on individual Polycom solution components, refer to product data sheets
- Standard Polycom Warranty applies to Polycom solution components

* Polycom MSR Dock with Surface Pro, Windows 10 Enterprise, and Microsoft Skype Room System v2 software is built and fulfilled by authorized Polycom MSR distributors.

Learn more

For more information regarding Polycom MSR series and other Polycom solutions for Office 365 and Skype for Business, contact us at TeamMicrosoft@polycom.com or visit www.polycom.com/microsoft.

About Polycom

Polycom helps organizations unleash the power of human collaboration. More than 400,000 companies and institutions worldwide defy distance with video, voice and content solutions from Polycom. Polycom and its global partner ecosystem provide flexible collaboration solutions for any environment that deliver the best user experience and unmatched investment protection.

Polycom, Inc.
1.800.POLYCOM
www.polycom.com

Polycom Asia Pacific Pte Ltd
+65 6389 9200
www.polycom.com.sg

Polycom EMEA
+44 (0)1753 723282
www.polycom.co.uk

