

EVI-HD7V NEW

EVI-HD3V NEW



EVI-HD7V



EVI-HD3V

Outline

The EVI-HD7V achieves digital image acquisition of up to 1080p/60 for exceptional picture quality. The EVI-HD3V provides superb image quality of up to 720p/60 at an affordable price. Both cameras are equipped with a DVI-I interface, enabling easy connection to a PC monitor.

Features

- 10x optical zoom lens Auto Focus Zoom
 - Horizontal angle of view 70 degrees (wide end) to 8 degrees (tele end)
 - $f = 3.4 \text{ mm}$ (wide) to 33.9 mm (tele), F1.8 to F2.1
- Wide-range, Quiet, and Quick Pan/Tilt Movement
 - Pan angle: -100 degrees to +100 degrees (max pan speed: 300 degrees/s)
 - Tilt angle: -25 degrees to +25 degrees (max tilt speed: 125 degrees/s)
- Six Position Presets
 - All models in the EVI HD Series can store up to a maximum of six preset settings for P/T/Z, focus position, exposure mode, and white balance mode.
- RS-232C Remote Control (MISCA™ Protocol)
- High-quality Image Transmission
 - The EVI-HD7V and EVI-HD3V are both equipped with a DVI-I interface that is designed to maximize high video quality of digital displays. This digital interface is capable of displaying both digital and analog signals (output is selectable from Y/Pb/Pr and RGB).

Dimensions

EVI-HD7V/EVI-HD3V: Same body size

Top

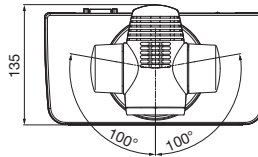

Side

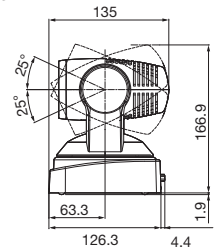

Front

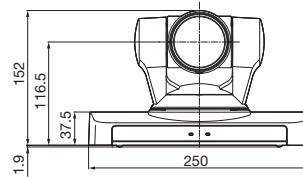

Bottom

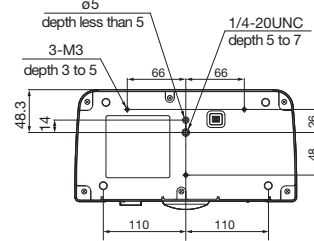

Unit: mm

[Image signal Chart]

LB: Letter Box

	EVI-HD7V	EVI-HD3V
1080p/59.94 1080p/50	●	
1080i/59.94 1080i/50	●	
1080p/29.97 1080p/25	●	
720p/59.94 720p/50	●	●
720p/29.97 720p/25	●	●
640 x 480p/59.94	● (LB)	● (LB)

Digital Video Camera XCG XCD XCL
 Intelligent XCI
 Analog Video Camera XC (Non-TV Format) XC (TV Format)
 Accessories
 Color Camera Module FCB
 Color PTZ Camera EVI

Specifications

	EVI-HD7V	EVI-HD3V
Image sensor	1/3-type CMOS	
Effective Number of Pixels	Approx. 2 Mega pixels	
Signal system	1080p/59.94, 1080p/50, 1080i/59.94, 1080i/50 1080p/29.97, 1080p/25, 720p/59.94, 720p/50, 720p/29.97, 720p/25, 640 × 480p/59.94 (Letter Box)	720p/59.94, 720p/50, 720p/29.97, 720p/25, 640 × 480p/59.96 (Letter Box)
Sync system	Internal	
Video out	DVI-I (Digital and Analog) Y/Pb/Pr, RGB Switchable	
Camera control	VISCA (IN/OUT) : Mini DIN 8-pin type, RS-232C, 9600 bps/38400 bps, Data: 8 bits, stop: 1 bit	
Lens	10x optical zoom f=3.4 mm (wide) to 33.9 mm (tele) F1.8 to F2.1	
Digital zoom	4x (40x with optical zoom)	
Horizontal angle of view	70 degrees (wide) to 8 degrees (tele) (When HD signal output)	
Minimum object distance	100 mm (wide end), 350 mm (tele end)	
S/N ratio	More than 50 dB	
Minimum illumination (Typical)	15 lx (F1.8, 50IRE)	
Shutter speed	1/60 sec to 1/10,000 sec (59.94 Hz system) 1/50 sec to 1/10,000 sec (50 Hz system)	
Gain	Auto, Manual (-3 dB to +18 dB, 3 dB 8 steps) with Max Gain Limit	
Exposure control	Auto / Manual / Priority AE / Exposure compensation / Bright	
Focus system	Auto/Manual	
White balance	Auto / Indoor / Outdoor / One push auto / Manual	
Position prese	6 positions	
Pan/Tilt	Horizontal : ±100 degrees (Maximum panning speed : 300 degrees/sec, When maximum speed is set with VISCA control) Vertical : ±25 degrees (Maximum tilting speed : 125 degrees/sec, When maximum speed is set with VISCA control)	
Ceiling mountable	No	
Installation angle	Less than ±15 degrees to the horizontal surface	
Storage temperature	-20°C to +60°C	
Operating temperature	0°C to 40°C	
Power requirements	DC 12 V (DC 10.8 V to 13.0 V)	
Power consumption	2.5 A max. (at 12 V DC)	
Power connector	JEITA type 4 (DC IN 12 V)	
Mass	Video Camera: 1.5 kg, Remote Commander: 109 g	
Dimensions (W × H × D)	Video Camera : 250 × 152 × 135 mm, Remote commander : 56 × 26 × 210 mm (not including protruding parts)	
Supplied accessories	AC power adaptor (1), AC power cord (1), Remote Commander (1), Operating Instructions (1)	

The values for mass and dimension are approximate.

* "VISCA" is a trademark of Sony Corporation

XCG
XCD
XCL

XCI

XC (Non-TV Format)

XC (TV Format)

Accessories

FCB

EVI